

# ZENITH 161-SERIES CARBURETORS

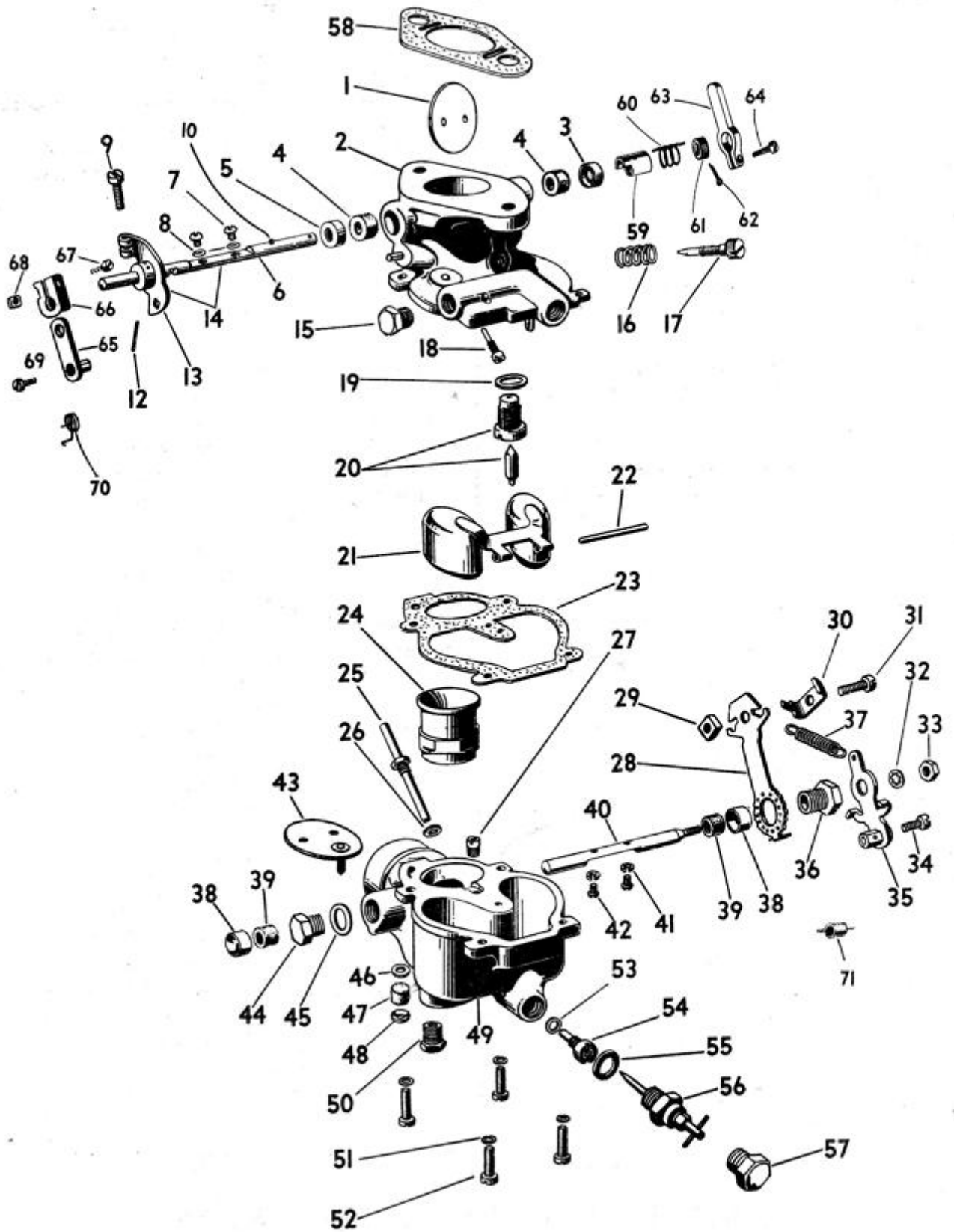

See reverse side for parts list

**161 Series CARBURETOR PARTS LIST**  
(Models 161-7, 161X7, 161J7, 161JX7, 161XX7)

Ref. No.	Part No.	Part Name	Ref. No.	Part No.	Part Name
1	C21-88	Plate—throttle	40		*Shaft—choke
2	B2-	*Body—throttle	41	T41-5	Lockwasher—plate screw
3	CR37-1X1	Plug—throttle shaft hole	42	T15B5-3	Screw—choke plate
4	CT57-4	Washer—throttle shaft packing	43	C101-17	Plate—choke
5	C131-4X2	Retainer—packing	43	C101-60	Plate—choke (special light valve spring)
7	T15B5-3	Screw—throttle plate	44	C138-24	Plug—choke shaft hole
8	T41-5	Lockwasher—plate screw		CR37-1X2	Plug—choke shaft hole (cup type)
9	T1S8-10	Screw—lever stop		CR137-19	Plug—choke shaft hole (solid type)
10	C121-12	Pin—throttle shaft	45	T56-23	Washer—choke shaft hole plug
14	C29-	*Shaft and Lever—throttle	46	CT52-7	Washer—intake drain
15	CT91-3	Plug—fuel inlet	47	CT57-12	Washer—drain felt
	C150-17	Elbow and Screen—fuel (I.H.C.)	48	CT93S-51	Retainer—felt washer
16	C111-9	Spring—idle adjusting needle	49	B3-	*Bowl—fuel
16	C111-17	Spring—idle adjusting needle (for C46-6 needle)	50	CT91-3	Plug—bowl drain
17	C46-25	Needle—idle adjusting		T150-1	Valve—bowl drain
17	C46-6	Needle—idle adjusting (No 12-32thd. I. H. C.)	51	T41-10	Lockwasher—bowl to body screw
18	C55-6-	†Jet—idle (specify size)	52	T1S10-10	Screw—bowl to body
19	T56-20	Washer—fuel valve seat	53	T56-24	Washer—main jet
20	C81-17-	†Valve and Seat—fuel (specify size)	54	C52-6-	†Jet—main (specify size)
21	C85-	*Float	55	T56-23	Washer—main passage plug
22	C120-4	Axle—float (brass)	56	C71-21	Adjustment—main jet
22	C120-42	Axle—float (stainless steel)	57	C138-23	Plug—main passage
23	C142-16	Gasket—bowl to body	58	C141-4-5	Gasket—flange (161-7)
24	C38-	†*Venturi (specify size)	58	C141-4-6	Gasket—flange (161X7)
25	C66-	†*Jet—discharge (specify size)	59	CR26-61	Bushing—throttle lever (brass)
26	T56-52	Washer—discharge jet	59	C26-81	Bushing—throttle lever (steel)
27	C77-18-	†Vent—well (specify size)	60	C117-27	Spring—throttle lever (R. H. coil)
28	C109-	*Bracket—choke	61	CR115-10	Retainer—spring
29	T21S8	Nut—clamp screw	62	T61-4	Cotter pin
30	C110-1	Clamp—bracket tube	63	C24-	*Lever—throttle clamp
31	T1S8-10	Screw—tube clamp	64	T8S10-9	Screw—lever clamp
32	T45-8	Lockwasher—shaft nut (No. 8)	65	C25-18X2	Lever—floating
32	T41-10	Lockwasher—shaft nut (No. 10)	66	C25-98AX2	Stop—floating lever
33	T22S8	Nut—choke shaft (No. 8-36 thd.)	67	T1S10-12	Screw—stop clamp
33	T22S10	Nut—choke shaft (No. 10-32 thd.)	68	T24S10	Nut—clamp screw
34	T1S8-6	Screw—swivel	69	T8S8-7	Screw—swivel
35		*Lever—choke	70	C117-6	Spring—floating lever (R. H.)
36	C140-2	Screw—bracket assembly	70	C117-8	Spring—floating lever (L. H.)
36	C140-7	Screw—bracket assembly (packed)	71	C117-13	Spring—choke lever (L. H. 6 coils)
37	C112-6	Spring—choke lever		C117-18	Spring—choke lever (L. H. 5½ coils)
38	C131-4X2	Retainer—packing		C117-36	Spring—choke lever (R. H. 5½ coils)
39	CT57-4	Washer—shaft packing		CR9-13	Bushing—throttle shaft
				C181-66	Gasket set
				K501	Basic repair kit

\* Refer to Specification Bulletin for complete part number or specify carburetor assembly number. † Calibrated part—specify size. Zenith service parts can be obtained promptly through our central and service distributors located in principal cities.

## ZENITH CARBURETOR DIVISION

696 HART AVENUE



DETROIT 14, MICHIGAN

*Manufacturers of Zenith Carburetors and Filters*