

GRAVELY STARTER

PRICES SUBJECT TO CHANGE WITHOUT NOTICE

KEY: NS-NOT SHOWN-ORDER BY DESCRIPTION

ILLUSTRATED PARTS AND PRICE LIST

EFFECTIVE OCTOBER 1, 1957

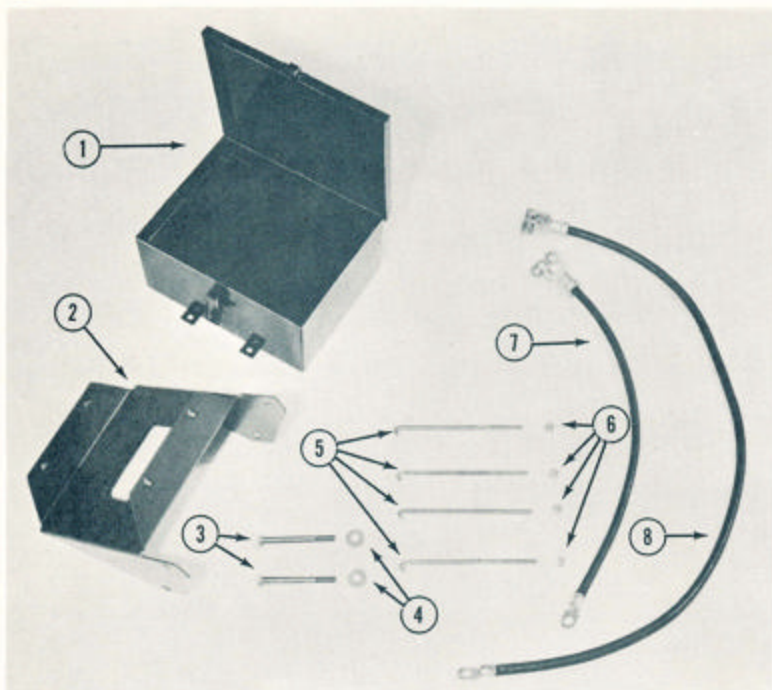

PLATE A

Photo No.	Part No.	Description	Price
1	ST-107	Battery Holddown Toolbox	4.68
2	ST-106	Battery Mounting Bracket	3.85
3	144-S	Battery Mounting Bracket Bolts	.15
4	402-W	Battery Mounting Bracket Bolt Washers	.01
5	ST-109	Battery Holddown Bolts	.28
6	201-N	Battery Holddown Bolt Nuts	.02
7	ST-113	Battery Ground Cable	1.76
8	ST-114	Battery to Switch Cable	2.64
NS	201-N	Hood Pivot Bolt Nuts (2 required per Bolt)	.02
NS	164-S	Hood Pivot Bolts (2 required)	.02
NS	ST-123	Hood (cut down)	1.76

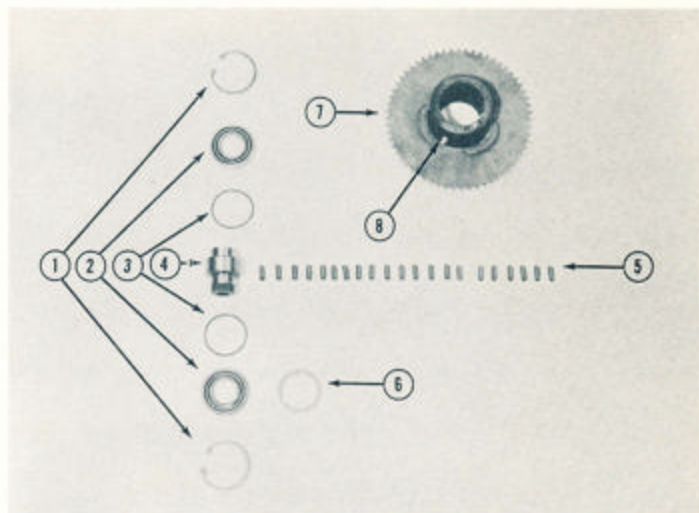

PLATE B

Photo No.	Part No.	Description	Price
1	HE-103	Clutch Shell Bearing Retaining Rings	.28 ea.
2	BB-111	Ball Bearings (Clutch Shell)	4.95 ea.
3	ST-120	Cam Roller Springs	.31 ea.
4	ST-118	Drive Nut	2.64
5	ST-119	Clutch Cam Rollers	.22 ea.
6	ST-122	Ball Bearing Shim	.06
7	ST-100 & 117	Sprocket and Clutch Shell (60 Tooth) (Welded Assembly)	11.28
8	901-G	Grease Fitting	.11



PLATE C

Photo No.	Part No.	Description	Price
1	ST-111	Motor	25.30
2	112-S	Mounting Bolts	.07
3	403-W	Motor Mounting Bolt Washer	.01
4	205-N	Motor Mounting Bolt Nuts	.03
5	ST-115	Switch to Motor Cable	.66
6	ST-104	Motor Sprocket (8 Tooth)	2.31
7	HE-102	Motor Sprocket Pin	.06
8	ST-108	Roller Chain	4.13
9	-----	Clutch and Sprocket Assembly Complete (See Plate C for parts)	29.71
11	110-S	Rear Hitch Angle Brace Bolt	.07
12	205-N	Rear Hitch Angle Brace Bolt Nut	.03
13	ST-105	Motor Mounting Plate	1.98
14	110-S	Motor Plate Bolt (To Fan Housing)	.07
15	403-W	Motor Plate Bolt Washer (To Fan Housing)	.01
16	205-N	Motor Plate Bolt Nut (To Fan Housing)	.03
17	L-514	Motor Plate Distance Spacer	.24
18	143-S	Motor Plate Bolt (To Crankcase)	.22
19	ST-112	Foot Switch	1.65
20	164-S	Switch Mounting Bolts	.02
21	201-N	Switch Mounting Bolt Nuts	.02
22	ST-121	Starter Fan Drive Pulley	4.40

"PRINTED IN U.S.A."