

- 1 - Axis
- 2 - Cotter Pin
- 3 - Washers
- 4 - Wheel

- 1 - Wheel Bracket
- 2 - Axis Clamp
- 3 - Bolt

FIGURE 1

FIGURE 2

GAUGE WHEEL KIT

Item No.	Description	Quantity
1	Bracket, Wheel	1
2	Axis Clamp	1
3	Bolt, Hex 1/2-13x1.50	1
4	Washer, Flat .812x1.49x.134	2
5	Cotter Pin, Cotter .187x1.62	1
6	Washer, Flat .812x1.49x.134	2
7	Wheel	1
8	Axis	1
9	Washer, Flat .812x1.49x.134	2
10	Holt-U, 3/8-16	2
11	Ring, Snap Truarc 5160-123	1
12	Support Tube	1
13	Washer, Flat .812x1.49x.134	2
14	Washer, Flat .812x1.49x.134	2
15	Washer, Flat .812x1.49x.134	2

SECTION 1

Illustrated Parts and Parts List

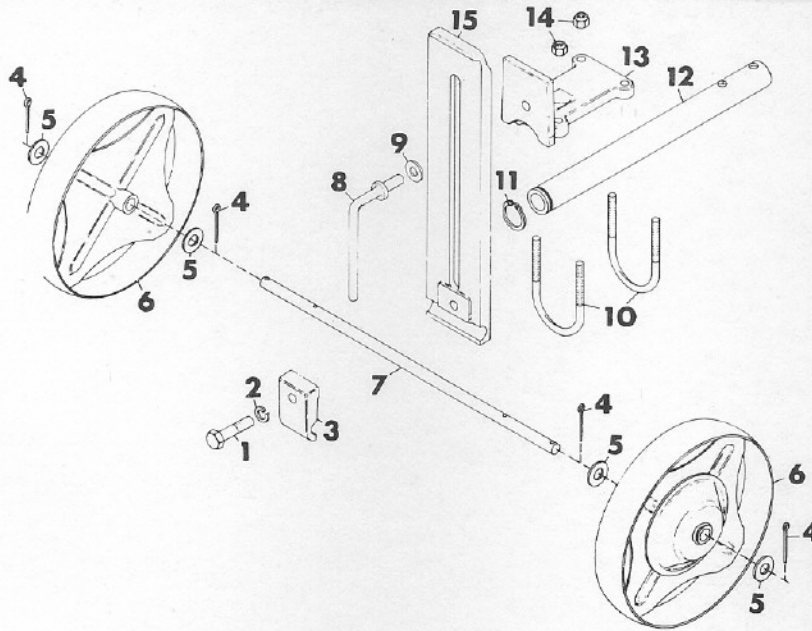

ITEM NO.	PART NO.	QTY.	DESCRIPTION
1	180177	1	Bolt, Hex 1/2-13x1.50
2	120384	1	Washer, Lock 1/2 Reg.
3	5304	1	Clamp, Axle
4	137253	4	Pin, Cotter .187x1.62
5	131017	4	Washer, Flat .812x1.496x.134
6	5327	2	Wheel, Depth
7	5311	1	Axle, Depth Wheel
8	5325	1	Screw, Wheel Bracket Clamp
9	120390	1	Washer, Flat .563x1.375x.109
10	22235	2	Bolt-U, 3/8-16
11	22233	1	Ring, Snap Truarc 5160-193
12	22232	1	Support, Tube
13	22234	1	Swivel, Wheel Bracket
14	413534	4	Nut, Lock 3/8-16
15	22236	1	Bracket, Wheel

SECTION 2

Assembly Instructions

1. Put the wheels on the axle with the hub to the outside as shown in Figure 1.

2. Fasten the wheel bracket and axle clamp to the axle with the 1/2-13x1.50 bolt and lock washer as shown in Figure 2.

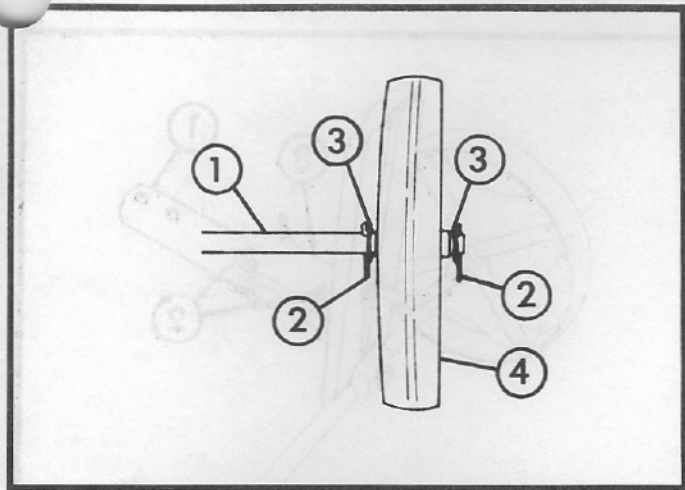

- 1 - Axle
- 2 - Cotter Pins
- 3 - Washers
- 4 - Wheel

FIGURE 1

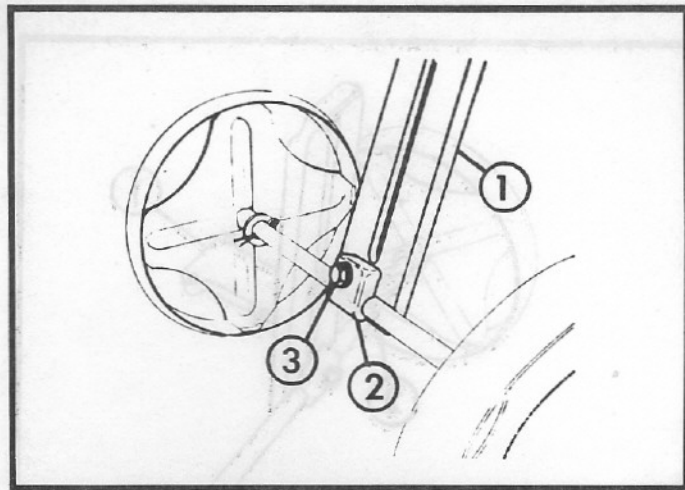

- 1 - Wheel Bracket
- 2 - Axle Clamp
- 3 - Bolt

FIGURE 2

3. Fasten the wheel bracket swivel to the wheel bracket with the flat washer and the wheel bracket clamp screw as shown in Figure 3.
4. Fasten the support tube to the bracket swivel with the two "U" bolts and 3/8" nuts as shown in Figure 4. Loosen the nuts on the "U" bolts until the support tube can be rotated on the bracket swivel.
5. Slide the support on the extension bar (part of the Lawn Renovator Kit). Retain with two 1/2-13x2.75 bolts and nuts.
6. Rotate the gauge wheel assembly until the axle is parallel with the tine shaft. Tighten the "U" bolts.
7. See Renovator Kit literature for operation instructions.

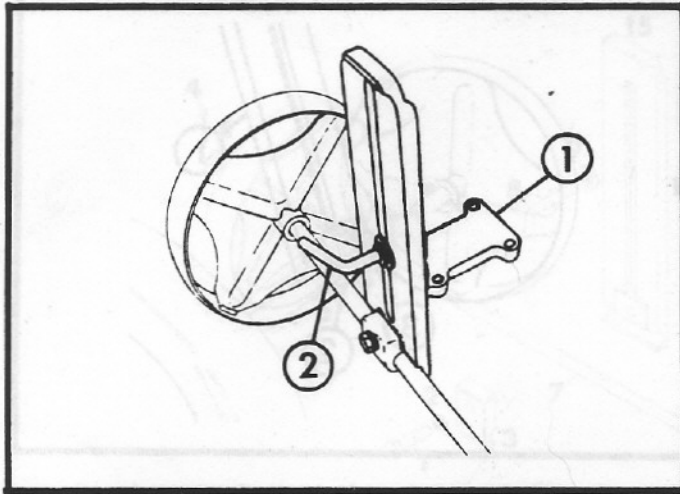

- 1 - Wheel Bracket Swivel
- 2 - Wheel Bracket Clamp Screw

FIGURE 3

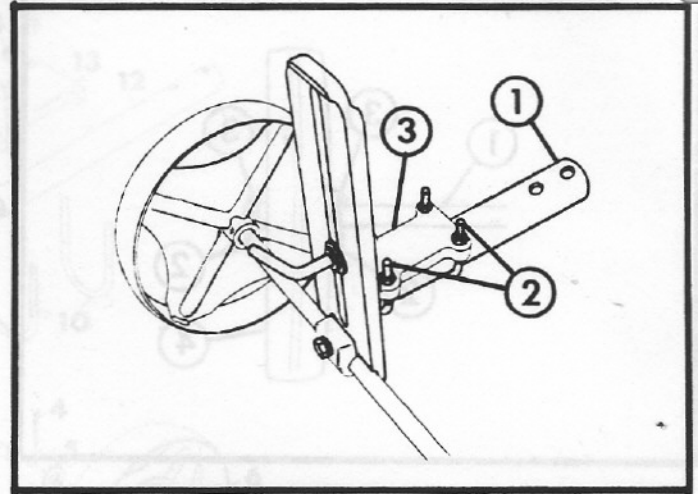

- 1 - Support Tube
- 2 - "U" Bolts
- 3 - Bracket Swivel

FIGURE 4

3. Fasten the wheel bracket swivel to the wheel bracket with the first washer and the wheel bracket clamp screw as shown in Figure 3. 29.1x78.1, retort, and 41.1x69.4, 1x18.1, tail, retort.

4. Fasten the support tube to the bracket swivel with the two "U" bolts and 3/8" nuts as shown in Figure 4. Loosen the nuts on the "U" bolts until the support tube can be rotated on the bracket swivel. 41.1x69.4, 1x18.1, tail, retort.

5. Rotate the gauge wheel assembly until the axis is parallel with the line shaft. Tighten the "U" bolts.

6. See Renovator Kit literature for operation instructions.

7. Rotate the gauge wheel assembly until the axis is parallel with the line shaft. Tighten the "U" bolts.

8. See Renovator Kit literature for operation instructions.