

If your customer wants a Super Hood, WITHOUT the Starter, you can furnish it. You must, however, purchase from us, and charge the customer for, the necessary parts required for attaching the Super Hood. SEE Section 3 of this Bulletin, "Installation of Super and Custom Hoods."

**DON'T BE CONFUSED. DON'T ORDER "SUPER" TRACTORS-- ORDER TRACTOR, ACCESSORIES, HOODS AS YOU REQUIRE THEM.**

Your cooperation will allow us to fill your orders much more promptly.

### 3. INSTALLATION OF SUPER AND CUSTOM HOODS

#### SUPER HOOD --

1. Bolt Hood Catch (A in Figure 1) to left side of Hood, using holes in Hood as guide. Be sure slotted portion of Catch faces rear of Hood.

2. A Pivot Plate (A in Figure 2) and Clip Spring (B in Figure 2) are used on each side of Hood (Locations marked by holes on each side near front) to hold Hood to Battery Mount. Figure 2 shows these parts installed on right side of Hood.

Bolt Clip Spring to side of Pivot Plate with holes before bolting Pivot Plate to Hood. Be sure Clip Spring is attached so that when complete assembly is bolted to Hood, curved portion of Clip Spring points downward, as shown in Figure 2.

Bolt Pivot Plate to Hood using side with slots. Slots provide space for adjustments which may be needed for Hood to clear Battery and Fuel Tank.

3. Insert end of Hood Support Rod (A in Figure 3) with hole in it through hole in Fan Housing Assembly, as shown in Figure 3. With Rod in position, insert Roll Pin through hole in Rod. NOTE: Current production Tractors have hole drilled in Fan Housing Assembly. If working on older Tractor, drill hole in approximate location shown in Figure 3 (9 1/2" from bottom and 1/4" from front of Fan Housing Assembly).

4. Place Hood on Tractor so that Clip Springs snap over rod (A in Figure 4) welded to Battery Mount.

5. Insert Hood Support Rod into slot in Hood Catch. To hold Hood in raised position, engage bend in end of Rod in slot in Hood Catch.

6. Be sure rubber Hood Channel (B in Figure 3) is in place on each Tractor Handle Bracket. Channels reduce vibration. NOTE: Current production Tractors have Hood Channels cemented to Tractor Handle Brackets. If working on a Tractor in stock, we recommend installing Hood Channels and cementing them to Tractor Handle Brackets.

Following are parts required for Super Hood (See attached exploded view):

<u>Drawing Number</u>	<u>Part Number</u>	<u>Part Description</u>	<u>Number Required</u>	<u>List Price (Each)</u>
1	ST-127	Hood, Super	1	\$ 6.00
2	L-846	Hood Channel, Rubber*	2	.05
3.	NT-10-ST-5	Truss Head Machine Screw	10	.02
4	ST-128	Hood Clip Spring	2	.10
5	ST-130	Hood Pivot Plate	2	.35
6	207-N	Hex Nut	10	.02
7.	ST-131	Hood Catch	1	.35
8	ST-129	Hood Support Rod	1	.40
9	2-RP-4	Roll Pin	1	.05
Not Shown	ST-106-A	Battery Mount**	1	4.50

\*Current production Tractors have Hood Channels installed. Order only if needed for installation of Hood on Tractors in stock.

\*\*If customer wants Super Hood without Starter, it is still necessary to install Battery Mount, as Hood is attached to rod welded to Battery Mount.

#### CUSTOM HOOD --

1. Remove Cap Screw and Flat Washer which hold each Tractor Handle to Tractor.

2. Place Hood on Tractor so that Hood overlaps Tractor Handles. Be sure Hood Channels (B in Figure 3) are on Tractor Handle Brackets.

3. Insert Hood Spacer Bushing into hole in Hood. Secure Hood to Tractor with Cap Screw and Flat Washer.

See Figure 5 for properly installed Hood. NOTE: In Figure 5, an optional Lock Washer has been used. This is next to Cap Screw. Large washer is Flat Washer. Hood Spacer Bushing is not visible.

Note: SUPER Hood is designed to raise only to the limit set by the Hood Support Rod. To remove the hood entirely, grasp hood at front and lift straight up and set aside. Caution: "Yanking" hood up beyond stop on Support Rod will cause Hood to be levered off the front rods.

Following are parts required for Custom Hood (See attached exploded view):

Drawing Number	Part Number	Part Description	Number Required	List Price (Each)
1	L-820-A	Hood, Custom	1	\$6.00
2	112-S	Cap Screw*	2	.07
23	L-821	Flat Washer*	2	.06
24	305-W	Hood Spacer Bushing	2	.01
33	L-846	Hood Channel, Rubber**	2	.05

\*Parts already on Tractor, securing Tractor Handles to Tractor.

\*\*Current production Tractors have Hood Channels installed. Order only if needed for installation of Hood on Tractors in stock.

#### 4. INSTALLING BATTERY ON SUPER TRACTOR

When installing the Starter on a Tractor to be equipped with the Super Hood, the Battery Cover and Tool Box (Part Number ST-107) cannot be used, inasmuch as the Super Hood does not have room for the Tool Box.

Instead, a new part, Battery Cover (Part Number ST-133) must be used. List price is \$1.50 each.

Also, remember that the modified Battery Mount (Part Number ST-106-A) must be used with the Super Hood. The modified Battery Mount (See Section 3 of this Bulletin, "Installation of Super and Custom Hoods") has a rod welded to it over which the Hood is clamped.

#### 5. PROPER GROUNDING OF BATTERY CABLE

Field reports indicate that the Battery Cable (Part Number ST-114) is being grounded improperly on the Super Tractor.

The Battery Cable which connects to the negative pole of the Battery should be grounded to the top mounting flange of the Starter. It should not be grounded to the Tractor Handle, as it is being done now in certain cases.

For user safety and satisfaction, be sure the Battery Cable is grounded to the Starter, and not to the Tractor Handle!

**6. GRAVELY TRACTORS' PROPER ADDRESS**

Our inquiry and mail processing work is being hampered, and some of your mail is being delayed, because some dealers are addressing letters to the street addresses shown on our literature or in our advertising.

These addresses, such as 101 Gravelly Lane, are used to key our advertising as a means of checking sources of inquiries. Use of these addresses for dealer correspondence causes delays.

Please address all dealer correspondence to:

GRAVELY TRACTORS  
DUNBAR, WEST VIRGINIA

This address will reach us quickly and accurately, and we'll be able to answer your correspondence much quicker. Again, please don't use the Gravelly Lane addresses; address your correspondence to:

GRAVELY TRACTORS  
DUNBAR, WEST VIRGINIA

**7. STOLEN TRACTOR**

Stolen Tractor, Serial Number probably in vicinity of M26,000. Included thirty-inch Rotary Mower. Sticking valve only clue. Probably will require service. Notify E. Earl Hansell, Hansell Bros., 1301 Maple Ave., Turtle Creek, Pennsylvania, or the Pennsylvania State Police.

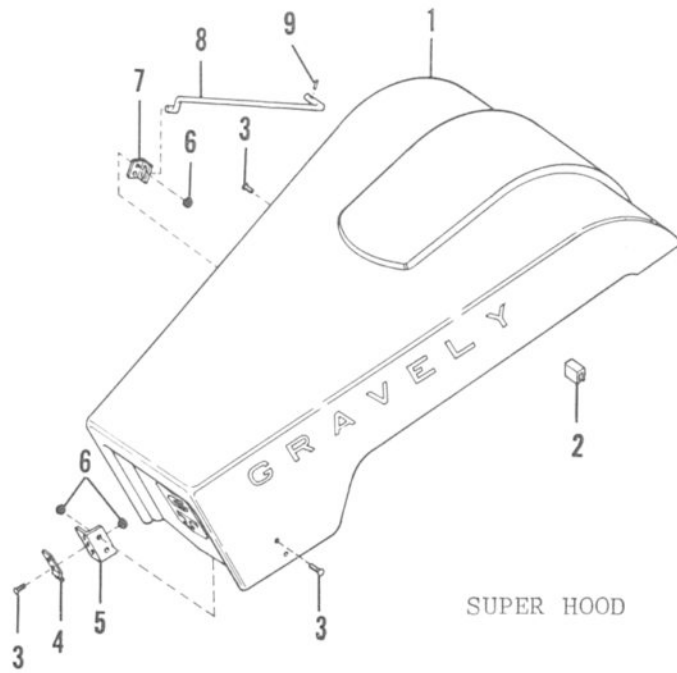

SUPER HOOD

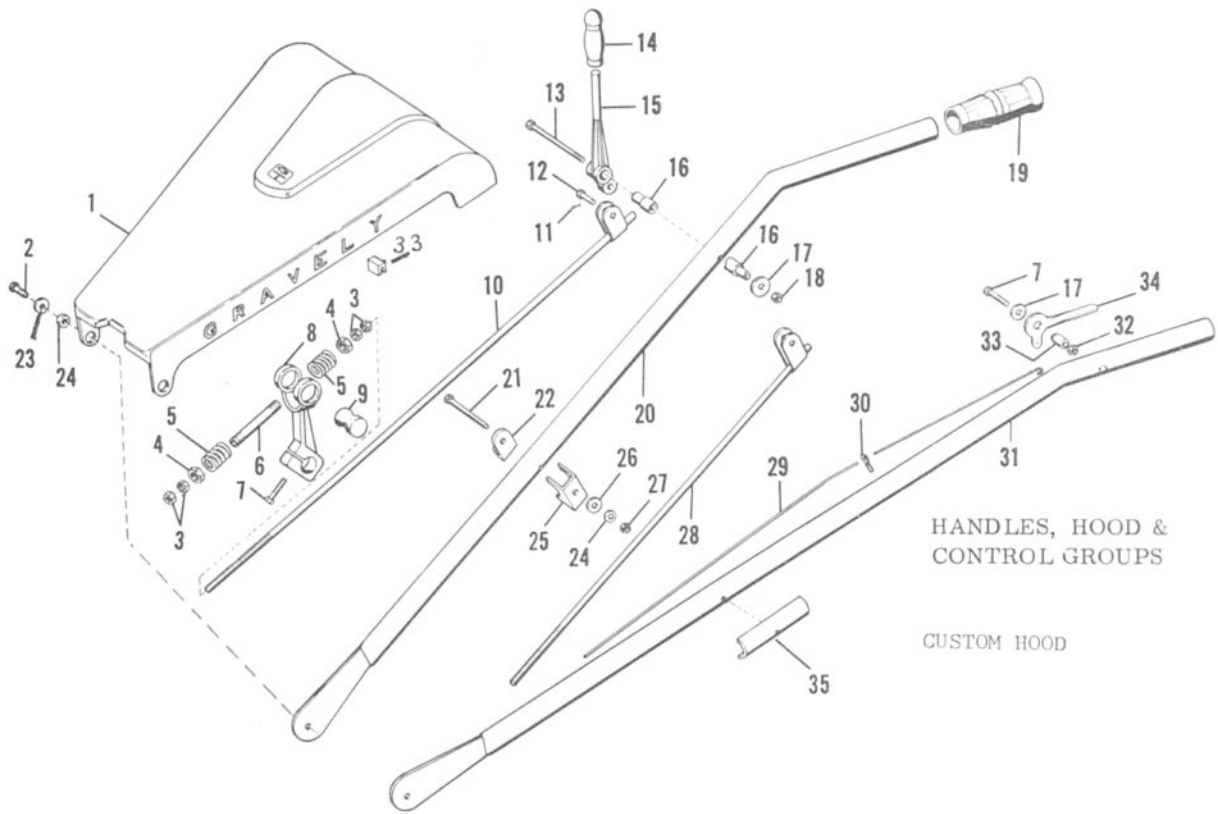

HANDLES, HOOD & CONTROL GROUPS

CUSTOM HOOD

LEFT SIDE  
OF HOOD

FRONT >

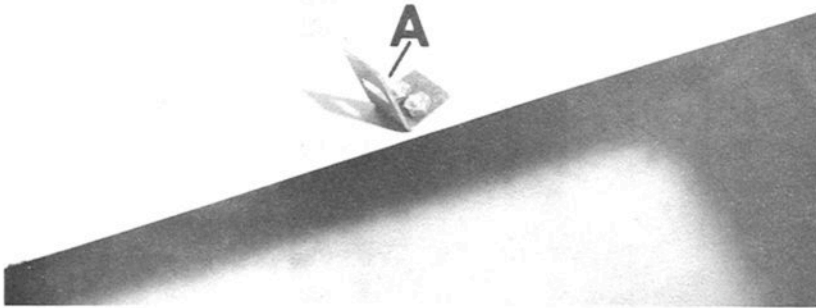

FIGURE 1

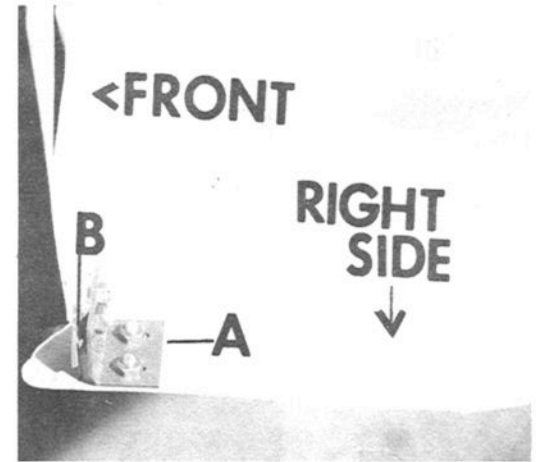

FIGURE 2

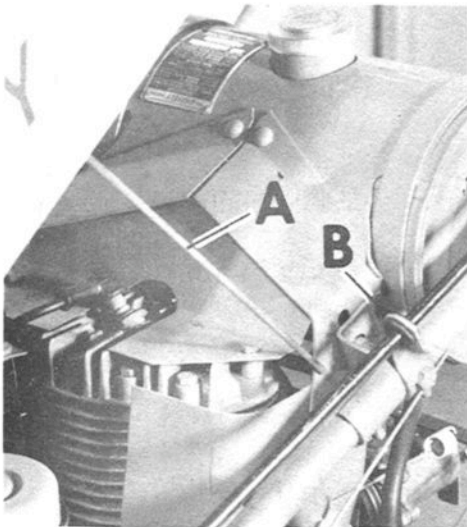

FIGURE 3

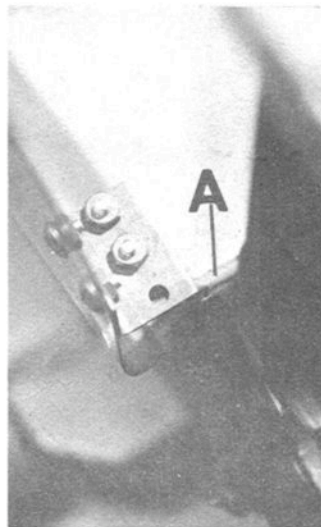

FIGURE 4

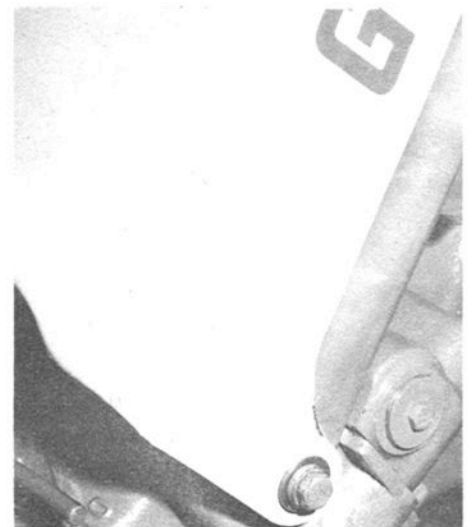

FIGURE 5