



Installation

1.1 Remove the boot kit from the shipping container.

NOTE: The boot kit is to be used in conjunction with the hinged discharge chute. When the boot is removed, the hinged discharge chute must be installed. The mower deck is fitted for the hinged discharge chute before the boot kit can be installed. The boot can be used while the hinged discharge chute is installed and in the raised position. When the boot is removed, the hinged discharge chute must be lowered before mowing.

- 1.2 Remove the hinged discharge chute and the right support.
- 1.3 Lay the hole template on the deck aligning the holes with the deck.
- 1.4 Drill two 7/16" diameter holes in the deck using the template.
- 1.5 Install the right support.
- 1.6 Turn the deck over and re-drill the outboard hole through the right support.

BOOT KIT 60" MOWER

- 1.7 Install the boot kit on the deck. Secure with two 3/8-16 lock nuts.
- 1.8 Using the boot kit, drill a 7/16" hole in the center of the deck.
- 1.9 Install a 3/8-16x1/2 carriage bolt in the hole and secure into the hole. Install a (flat washer and 3/8-16 lock nut).
- 1.10 Loosen the bolt holding the right support. Remove the rear bolt holding the right support.
- 1.11 Slide the boot kit over the hole and right support. Using the support as a guide, drill through the support mounting hole and boot with a 7/16" drill bit. Install and tighten hardware.
- 1.12 Using the boot kit, drill a 7/16" diameter hole in the rear of the deck.
- 1.13 Install a 3/8-16x1 bolt in the hole and secure with a flat washer and 3/8-16 lock nut.
- 1.14 Put a clamp over each end of the tube.
- 1.15 Put one end of the tube on the boot and the other on the hinged chute. Tighten the clamps.

SECTION 1

Installation

- 1.1 Remove the boot kit from the shipping container.

NOTE: The boot kit is to be used in conjunction with the hinged discharge chute. When the boot is removed, the hinged discharge chute must be installed. The mower must be fitted for the hinged discharge chute before the boot kit can be installed. The boot can be used while the hinged discharge chute is mounted and in the raised position. After the boot is removed, the hinged discharge chute is lowered before mowing.

- 1.2 Remove the hinged discharge chute and the right support.
- 1.3 Lay the hole template on the deck aligning the holes used to mount the right support.
- 1.4 Drill two 7/16" diameter holes as indicated on the template.
- 1.5 Install the right support.
- 1.6 Turn the deck over and redrill the outboard hole through the right support.
- 1.7 Install the baffle from underneath the deck. Secure with two 3/8-16 lock nuts.
- 1.8 Using the baffle for a guide, drill a 7/16 hole in the rear of the deck.
- 1.9 Install a 3/8-16x3/4 carriage bolt from the baffle side into the hole. Install a flat washer and 3/8-16 lock nut.
- 1.10 Loosen the bolts holding the right support. Remove the rear bolt holding the right support.
- 1.11 Slide the boot in position under the right support. Using the support as a guide, drill through rear support mounting hole and boot with a 13/32 drill. Install and tighten hardware.
- 1.12 Using the boot for a guide, drill a 7/16" diameter hole in the rear of the deck.
- 1.13 Install a 3/8-16x1 bolt in the hole and secure with a flat washer and 3/8-16 lock nut.
- 1.14 Put a clamp over each end of the tube.
- 1.15 Put one end of the tube on the boot and the other on the blower inlet. Tighten the clamps.

SECTION 2

Illustrated Parts and Parts Lists

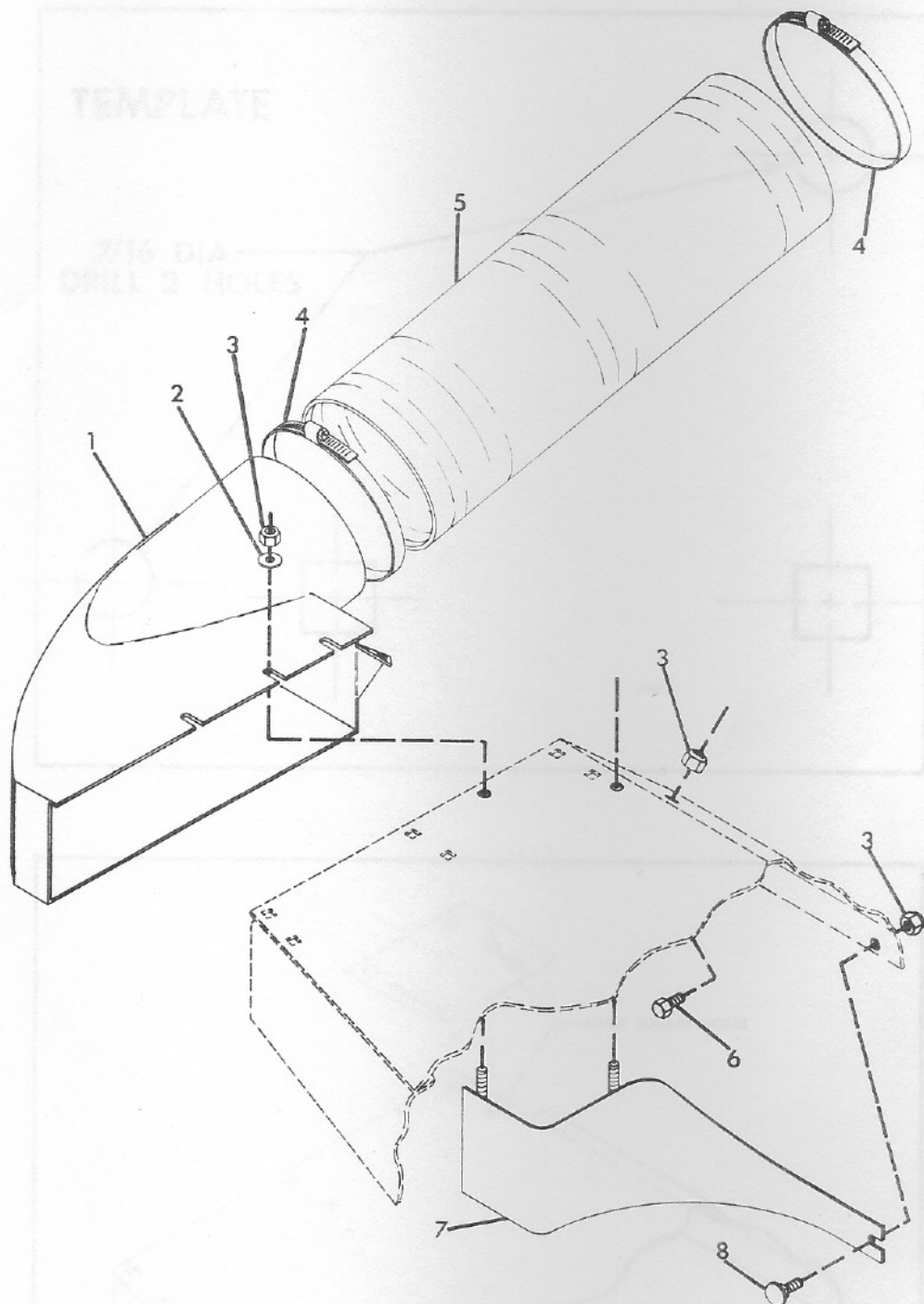

ITEM NO.	PART NO.	QTY.	DESCRIPTION
1	37839	1	Chute, 60" Discharge
2	120394	2	Washer, Flat .406x.812x.065
3	456004	4	Nut, Lock 3/8-16
4	36996	2	Clamp
5	41600	1	Hose, Mower to Blower
6	180122	1	Bolt, Hex 3/8-16x1
7	37902	1	Weldment, Baffle
8	126227	1	Bolt, Carriage 3/8-16x.75

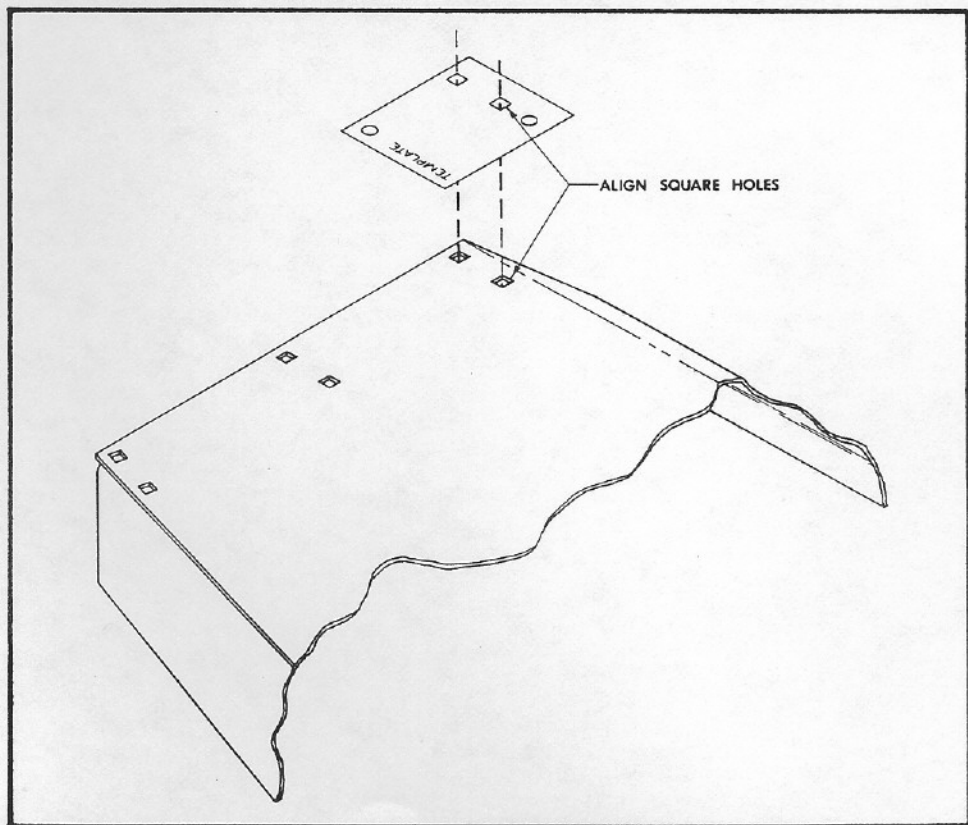
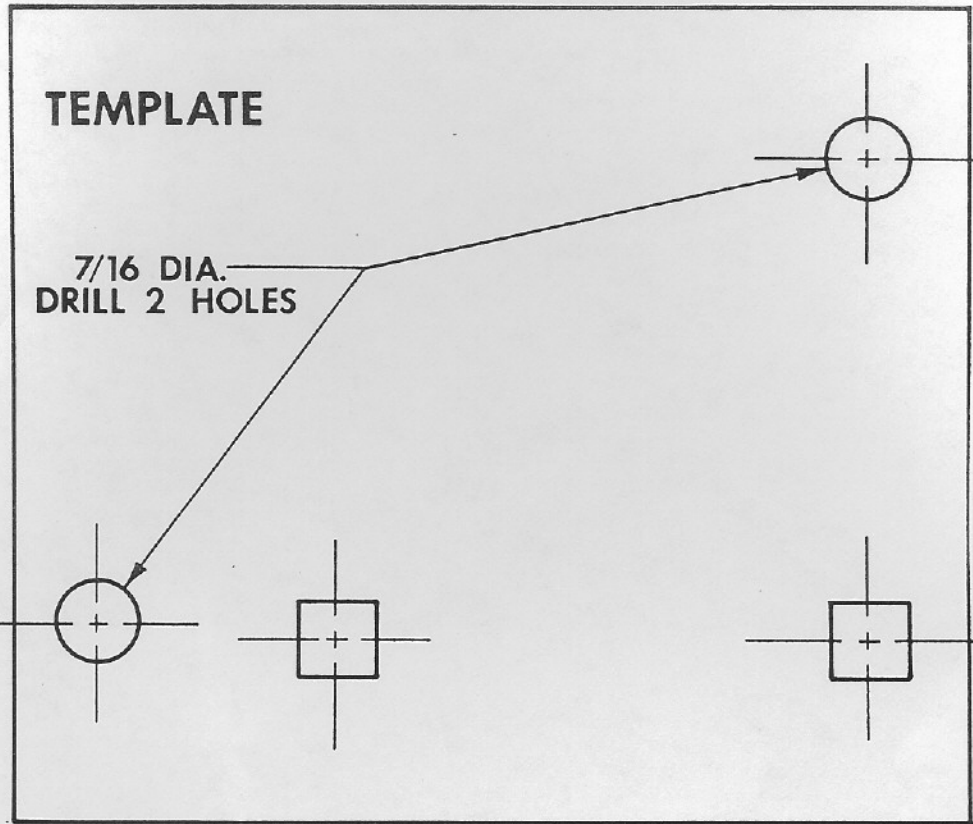

Template Location