

continue its program of quality and design improvement, the manufacturer reserves the right to change specifications, designs or prices without notice and without incurring obligation.

**Rotary Mower, Chain
 and Circular Saw DRIVE**

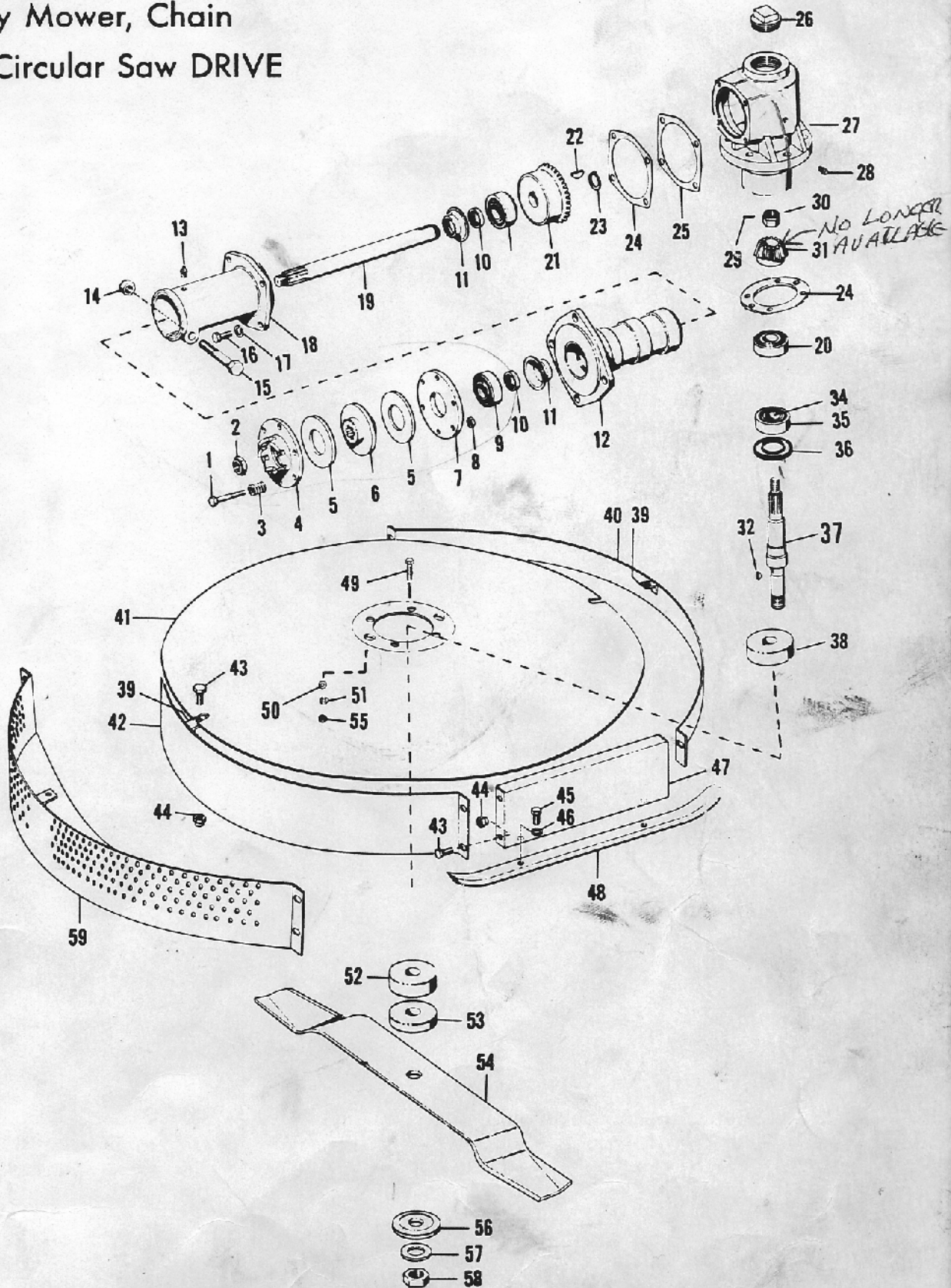

ROTARY MOWER AND DRIVE PARTS LIST

MODELS: 185, 58-A, 58

KEY NO.	NO. REQ'D	NAME AND DESCRIPTION	PART NO. MODELS 58-A & 185	PART NO. MODEL 58	NEW PART NUMBER
1.	6	Spring Bolt, Safety Clutch	SC-37	SC-37	181618
2.	1	5/8"-18 NF Nut, Safety Clutch to drive shaft	227-N	227-N	13412P1
3.	6	Spring, Safety Clutch	SC-35	SC-35	12871P1
4.	1	Dog Plate, Safety Clutch	SC-30	SC-30	12867P1
5.	5	Friction Washer, Safety Clutch	SC-34	SC-34	12870P1
6.	6	Drive Plate, Splined Safety Clutch	SC-33-SA	SC-33-SA	12869P1
7.	1	Back Plate, Safety Clutch	SC-32	SC-32	12868P1
8.	6	Jam Hex Nut, Safety Clutch	215-N	215-N	18277P1
9.	2	Timken Roller Bearing, for Swivel Casting	RB-113-R&C	RB-113-R&C	R=13143P1 C=13144P1
10.	2	Oil Seal, Swivel Casting	OS-112	OS-112	13122P1
11.	2	Oil Seal Retainer	A-474	A-474	12550P1
12.	1	Drive Shaft Housing	A-148	A-148	11315P1
13.	1	Grease Fitting, Swivel Casting	903-G	903-G	411010
14.	1	1/2"-13NC Nut, for 172-S Screw	241-N	241-N	435507
15.	1	1/2"-13 NC Bolt, Swivel Casting Clamp	172-S	172-S	180191
16.	4	Hex. Hd. Cap Screw, Swivel Casting to Gear Housing	110-S	110-S	180121
17.	4	Lock Washer, for 110-S Bolts	305-W	305-W	138542
18.	1	Swivel Casting	A-149	A-149	12023P1
19.	1	Drive Shaft, in Swivel Casting	A-475	A-475	12566P1
20/34/35	2	Bearings for Rotor Shaft			
		1 each	RB-113 R&C (top)	2 req'd	R=13144P1 C=13144P1
		1 each	RB-110-E (bottom)		13139P1
		1 each	RB-112-C (bottom)		13142P1
21.	1	Bevel Gear (large Size)	RO-341(mates with RO-342) 27 tooth, 13/16" bore	RO-341-(mates with RO-342) 27 tooth, 13/16" bore	12862P1 12863P1
22.	1	Woodruff Key for Key No. 21 Bevel Gear	510-K	510-K	103907
23.	1	Snap Ring for RO-341 Gear to Shaft	RR-110	RR-110	13187P1
24.		Shims - Gear Housing adjusting .005 and .020 thickness	SH-114	AH-114	.005-12490P1

24.		Shims - Gear Housing Adjusting .005 and .020 thickness	SH-114	SH-114	SH-114	.005 - 12490P
25.	2	Gasket, Gear Housing	M-488	M-488	M-488	12491P1
26.	1	Oil Filter Plug, for Gear Housing	702-P(not vented)	702-P(not vented)	702-P(not vented)	103880
27.	1	Gear Housing	RO-102	RO-102	RO-102	13162P1
28.	1	Oil Level Plug, for Gear Housing	701-P	701-P	not req'd	103877
29.	1	Cotter Pin, for 219-N Pinion Nut	not req'd	not req'd	not req'd	not req'd
30.	1	Pinion Nut, for RO-342 Gear	RO-311	RO-311	RO-311	13159P1
31.	1	Bevel Pinion, Small Size	RO-305 mates with RO-304-A 16 tooth 1" bore	RO-305 mates with RO-304-A 16 tooth 1" bore also order RO-304	RO-305 mates with RO-304-A 16 tooth 1" bore also order Ro-304	13154P1
32.	2	Woodruff Key, for RO-342, RO-305 Gear and RO-339 Collar	504-K	504-K	504-K	124549
33.	1	Bearing Housing, Lower	RO-104	RO-104	RO-104	Cancel
Not Shown	1	Upper Bearing Housing	RO-103	RO-103	RO-103	Cancel
Not Shown	1	Ret. Ring for Upper Brg. Housing	RR-205	RR-205	RR-205	14088P1
Not Shown	4	Bolts for Upper Brg. Housing	110-S	110-S	110-S	180121
Not Shown	4	Lockwashers for Upper Brg.	305-W	305-W	305-W	138542
Not Shown		Bearing Spacers for Brg. Brg. (optional, only to reduce excessive end play	2211	2211	2211	Cancel
34.	1	Timken Bearing Cone, for RO-343	not req'd ¹³¹³⁹	not req'd	not req'd	not req'd
35.	1	Timken Bearing Cup, for RO-343	not req'd ¹³¹⁴²	not req'd	not req'd	
36.	1	Rotor Oil Seal	RO-306	RO-306	RO-306	14083
37.	1	Rotor Shaft	RO-322	RO-322	Cancel	13210P1
38.	1	Fixed Collar, Keywaxed	RO-323	RO-323	Cancel	13169P1
39.	2	Fender Bracket	RO-317	RO-317	RO-317	12857P1
40.	1	Front Fender	RO-316	RO-316	RO-316	12856P1
39/40	1	Front Fender and Bracket welded assembly	RO-317/RO-316	RO-317/RO-316	RO-317/RO-316	RO-317=12857 RO-316=12856
41.	1	Rotor Guard	RO-313	RO-313	RO-313	10110A3
41/47		ASSEMBLY: 1 Rotor Guard and 2 Skid Panels, welded assembly	RO-313/RO-314	RO-313/RO-314	RO-313/RO-314	RO-313=10110A RO-314=10110A
42.	1	Rear Fender	RO-315	RO-315	RO-315	10109A1
39/42	1	Rear Fender & Bracket welded assembly	RO-317/RO-315	RO-317/RO-315	RO-317/RO-315	RO-315=10109A RO-317=10109A
43.	8	Hex Hd. Cap Screw, fender securing	114-S	114-S	114-S	181596
44.	8	Nut, for 114-S Bolt	233-N	233-N	233-N	190139

45.	4	Hex. Hd. Cap Screw, Skid to Panel	115-S	115-S	115-S	181593
46.	4	Lock Washer for 115-S Bolt	303-W	304-W	304-W	138538
47.	2	Skid Panel	RO-314	RO-314	RO-314	12855P1
48.	2	Skid	RO-318	RO-318	RO-318	9223P1
49.	Opt.	Guard Flange	RO-335	RO-335	RO-335	13196P1
50.	4	Rotor Guard Stud, to Gear Hsg. (or use 112-S Bolt)	RO-340	RO-340	RO-340	13170P1
Not Shown	4	Locking Clip, For Key#50	RO-345	RO-345	RO-345	13172P1
51.	4	Guard Nut, for RO-340 Studs	243-N	243-N	243-N	192481
52.	1	Loose Collar, 3/4" thick	RO-326	RO-326	Cancel	12858P1
53.	1	Loose Collar, 1/2" thick	RO-325	RO-325	Cancel	12858P1
54.	1	Rotary Blade	RO-321 (left hand)	RO-321 (left hand)	Cancel	RO-321-13195P1
56.	1	Loose Collar, 1/4" thick	RO-324	RO-324	Cancel	12858P1
57.	2	Washer, For 244-N Nut and RO-327	414-W	414-W	414-W	131018
58.	1	Nut for Rotor Shaft	RO-327	RO-327	Cancel	14081P1
59.		Leaf Mulcher				
Not Shown		Shims, optional, end play adjustment	RO-334	RO-334	not req'd	14082P1

2857
2856

0110A
0110A

0109A
0109A

ROTARY MOWER AND DRIVE PARTS LIST
MODELS 56, 57, 53,54, 55, 52

KEY NO.	NO REQ'D	NAME AND DESCRIPTION	PART NO. MODEL 56 & 57	PART NO. MODELS 53,54,55	PART NO. MODEL 52	NEW PART NUMBER
1.	6	Spring Bolt, Safety Clutch	SC-37	SC-37	SC-37	181618
2.	1	5/8"-18 NF Nut, Safety Clutch to drive shaft	227-N	227-N	227-N	13412P1
3.	6	Spring, Safety Clutch	SC-35	SC-35	SC-35	12871P1
4.	1	Dog Plate, Safety Clutch	SC-30	SC-30	SC-30	12867P1
5.	5	Friction Washer, Safety Clutch	SC-34	SC-34	SC-34	12870P1
6.	6	Drive Plate, Splined, Safety Clutch	SC-33-SA	SC-33-S	SC-33-S	12861P1
7.	1	Back Plate, Safety Clutch	SC-32	SC-32	SC-32	12868P1
8.	6	Jam Hex Nut, Safety Clutch	215-N	215-N	215-N	18277P1
9.	2	Timken Roller Bearing, for Swivel Casting	RB-113-R & C	1 ea. req'd 3147-R & C M-478-R L-610-C	1 ea. req'd 3147- R & C M-478-R L-610-C	R=13143P1 C=13144P1 13901P1 13900P1 13122P1
10.	2	Oil Seal, Swivel Casting	OS-112	1 ea. req'd M-530 M-459	1 ea. req'd M-530 M-459	13122P1 13898P1
11.	2	Oil Seal Retainer	A-474	not req'd	not req'd	12552P1
12.	1	Drive Shaft Housing	A-148	M-150	M-150	Cancel
13.	1	Grease Fitting, Swivel Casting	903-G	903-G	903-G	411010
14.	1	1/2"-13 NC Nut, for 172-S Screw	241-N	241-N	241-N	435507
15.	1	1/2"-13 NC Bolt, Swivel Casting Clamp	172-S	172-S or LH-560	172-S or LH-560	130111
16.	4	Hex Hd. Cap Screw, Swivel Casting to Gear Housing	110-S	110-S	110-S	160121
17.	4	Lock Washer, for 110-S Bolts	305-W	305-W	305-W	138542
18.	1	Swivel Casting	A-149	M-181	M-181	A-149 - 12023 M-181 - 13888
19.	1	Drive Shaft, in Swivel Casting	A-475	RO-301-S	RO-301-S	A-475 - 12566 RO-301-S 13168
20/34/35	2	Bearings for Rotor Shaft	2 req'd BB-109	2 req'd BB-109	2 req'd BB-109	14390P1
21.	1	Bevel Gear (large size)	RO-304-A (mates with RO-305) 24 tooth, 13/16" bore	RO-304 (mates with RO-305) 24 tooth, 1" bore also order RO-305	RO-304 (mates with RO-305) 24 tooth, 1" bore also order RO-305	Cancel
22.	1	Woodruff Key for Key#21 Bevel Gear	510-K	510-K	510-K	103907
23.	1	Snap Ring for RO-341 Gear	RR-110	not req'd	not req'd	13187P1

25.	2	Gasket, Gear Housing	M-488	M-488	12491P1
26.	1	Oil Filler plug, for Gear Housing	702-VP (vented)	702-VP (vented)	13403P1
27.	1	Gear Housing	RO-105	RO-105	13165P1
28.	1	Oil Level Plug, for Gear Housing	701-P	701-P	103877
29.	1	Cotter Pin, for 219-N Pinion Nut	607-C	not req'd	119120
30.	1	Pinion Nut, for RO-342 Gear	219-N	227-N	219-N 125267 227-N 13412P
31.	1	Bevel Pinion, Small Size	RO-342 (mates with RO-341) 15 tooth 13/16" bore	RO-342 (mates with RO-341) 15 tooth 13/16" bore	12863P1
32.	2	Woodruff Key, for RO-342 RO-305 Gear and RO-339 Collar	504-K	504-K	124549
33.	1	Bearing Housing, Lower	R-107 3-1/4" dia.	R-106 2-3/4" dia.	RO-107- 13167 RO-106- 13166
Not Shown 1		Upper Bearing Housing	not req'd	not req'd	
Not Shown 1		Ret. Ring for Upper Brg. Housing	not req'd	not req'd	
Not Shown 4		Bolts for Upper Brg. Housing	not req'd	not req'd	
Not Shown 4		Lockwashers for Upper Brg. Housing	not req'd	not req'd	
Not Shown		Bearing Spacers for Brg. Housing (optional, only to reduce excessive end play)	not req'd	not req'd	
34.	1	Timken Bearing Cone, for RO-343 Shaft	RB-112-C	not req'd	13142P1
35.	1	Timken Bearing Cup, for RO-343 Shaft	RB-110-R	not req'd	13139P1
36.	1	Rotor Oil Seal	RO-344 1-3/8" I.D.	RO-338 1-1/8" I.D.	RO-334 13171 RO-338 14083 RO-343 13198 RO-337 13197
37.	1	Rotor Shaft	RO-343	RO-337	
38.	1	Fixed Collar, Keywayed	RO-339	RO-339-A*	12861P1
39.	2	Fender Bracket	RO-317	RO-317	12857P1
40.	1	Front Fender	RO-316	RO-316	12856P1
39/40	1	Front Fender and Bracket welded assembly	RO-317/RO-317	RO-317/RO-316	10108A1
41.	1	Rotor Guard	RO-313	RO-313	10110A3
41/47		ASSEMBLY: 1 Rotor Guard and 2 Skid Panels, welded assembly	RO-313/RO-314	RO-313/RO-314	10110A3
42	1	Rear Fender	RO-315	RO-315	10109A1
39/42	1	Rear Fender and Bracket, welded assembly	RO-317/RO-315	RO-317/RO-315	10109A1
43.	8	Hex. Hd. Cap Screw, fender securing	114-S	114-S	181596

44.	8	Nut, for 114-S Bolt	223-N		233-N	
45.	4	Hex. Hd. Cap Screw, Skid to Panel	115-S		115-S	181593
46.	4	Lock Washer, for 115-S Bolt	304-W		304-W	138538
47.	2	Skid Panel	RO-314		RO-314	12855P1
48.	2	Skid	RO-318		RO-318	9223P2
49.	Opt.	Guard Flange	RO-335		RO-335	13196P1
50.	4	Rotor Guard Stud, to Gear Housing (or use 112-S Bolt)	RO-340		RO-340	13170P1
Not Shown	4	Locking Clip, for Key #50	RO-345		RO-345	13172P1
51.	4	Guard Nut, for RO-340 Studs	243-N		243-N	192481
52.	1	Loose Collar, 3/4" thick	RO-326		RO-326	12858P1
53.	1	Loose Collar, 1/2" thick	RO-325		RO-325	12858P1
54.	2	Rotary Blade	RO-336 Right Hand		RO-336 Right Hand	12860P1
55.	1	Spacing Washer	RO-332		RO-332	12859P1
56.	1	Loose Collar, 1/4" thick	RO-324		RO-324	12858P1
57.	2	Washer, for 244-N Nut RO-327	414-W		414-W	131018
58.	1	Nut, for Rotor Shaft	244-N		244-N	451543
59.		Leaf Mulcher				
Not Shown		Rotor Bolt, securing blades through hollow shaft	not req'd		not req'd	
Not Shown		Shims, optional, end play adjustment	not req'd		not req'd	