

**10 H.P. & 12 H.P.
KOHLEK ENGINE
MUFFLER KIT**

SECTION 1

INSTALLATION INSTRUCTIONS

1. Remove the two socket head cap screws, two lock washers, the muffler and the exhaust gasket from the engine.
2. Fasten the new exhaust gasket and exhaust header to the engine with the two 5/16-18x.75 socket head cap screws and 5/16 lock washers. See the illustration in Section 2.
3. Slide the pipe in one end of the muffler over the end of the exhaust header and fasten with the muffler clamp, but do not completely tighten.
4. Fasten one end of the brace to the battery bracket weldment with a 1/4-20x.75 hex bolt, flat washer and lock nut, but do not completely tighten. Install the hardware through the hole in the battery bracket weldment which is nearest the bottom.
5. Fasten the other end of the brace to the tab on the end of the muffler with a 1/4-20x.75 hex bolt, two flat washers and a 1/4-20 lock nut. Tighten all the hardware and the muffler clamp.

DESCRIPTION	QTY.	PART NO.	ITEM NO.
Muffler 18 H.P.	1	44399	1
Weld. Lock 1/4-20	2	410454	2
Washer, Flat 5/16x.75x.032	3	120886	3
Bolt, Hex 1/4-20x.75	2	180020	4
Brace	1	42567	5
Gasket, Exhaust	1	11202	6
Washer, Lock 5/16x.75	2	120214	7
Socket Cap S. 5/16x.75 SHD	2	421705	8
Header, Exhaust	1	44481	9
Clamp, Muffler	1	14229	10

SECTION 2

ILLUSTRATED PARTS AND PARTS LIST

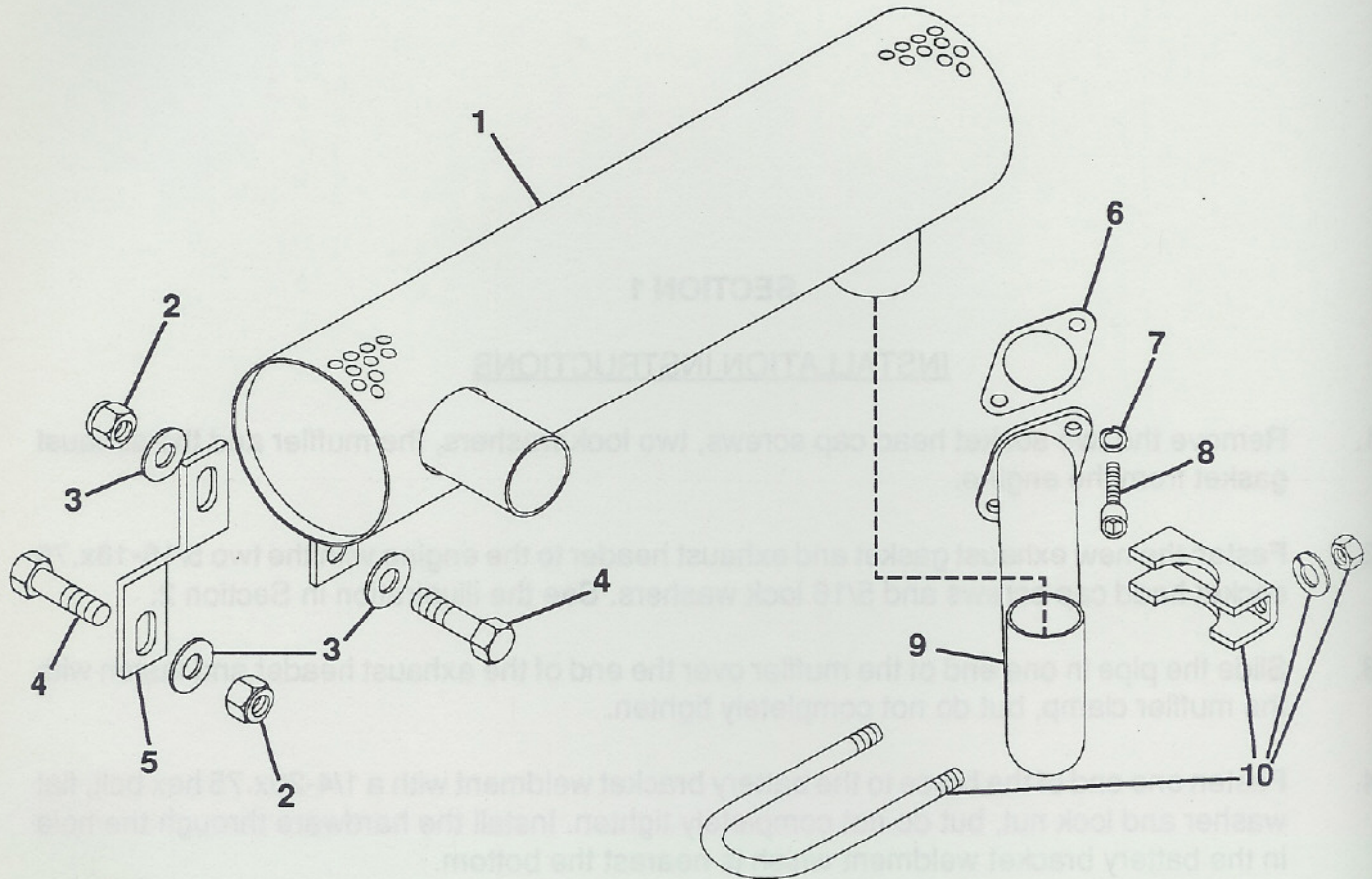

ITEM NO.	PART NO.	QTY.	DESCRIPTION
1	44399	1	Muffler, 16 H.P.
2	419454	2	Nut, Lock 1/4-20
3	120386	3	Washer, Flat .312x.734x.065
4	180020	2	Bolt, Hex 1/4-20x.75
5	43267	1	Brace
6	11202	1	Gasket, Exhaust
7	120214	2	Washer, Lock 5/16 Reg.
8	421705	2	Screw, Cap 5/16-18x.75 SHD
9	44461	1	Header, Exhaust
10	14728	1	Clamp, Muffler